

STC100

1 Drawer Workbench

OWNER'S MANUAL

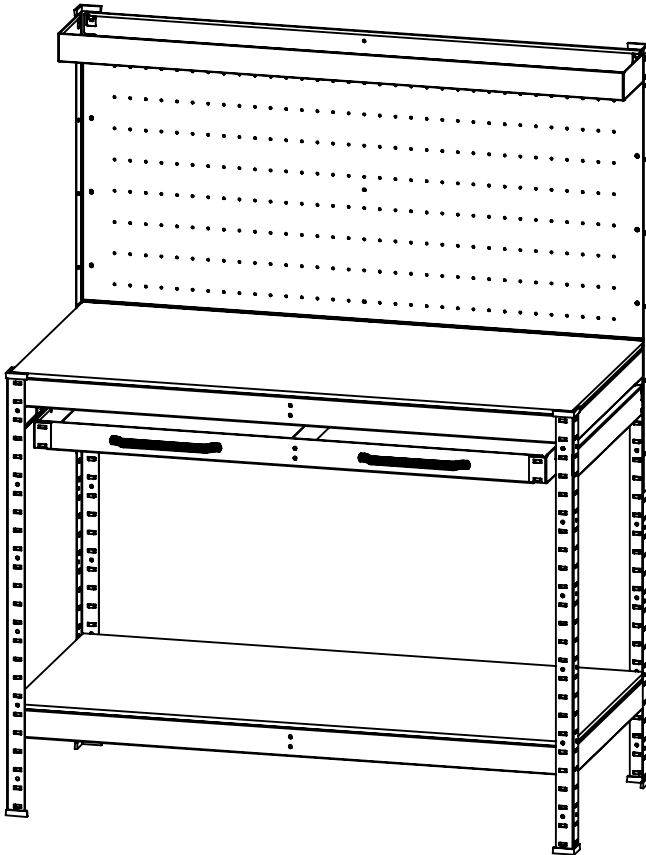

FOR YOUR SAFETY
PLEASE READ THESE INSTRUCTIONS CAREFULLY
AND RETAIN THEM FOR FUTURE USE.



INSTRUCTIONS FOR UNIT ASSEMBLY

Part No. STC100

Please read instructions carefully before assembly

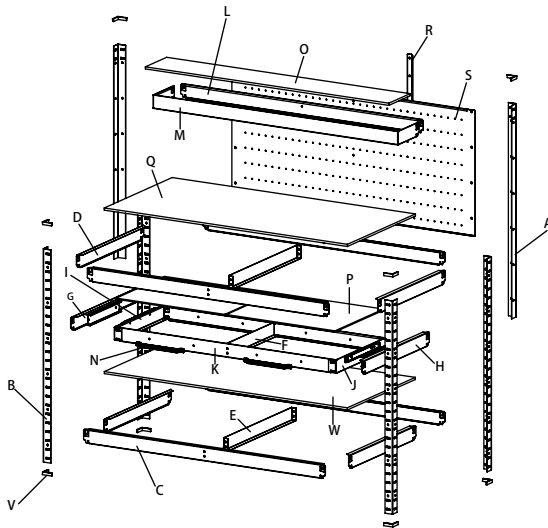

Parts Check list		
A	Pegboard Angles	2
B	Leg Angles	4
C	Long Shelf Support Bars	4
D	Short Shelf Support Bars	4
E	Centre Shelf Support Bars	2
F	Drawer Centre Divider	1
G	Drawer Support Bar & Slide (LH)	1
H	Drawer Support Bar & Slide (RH)	1
I	Drawer End & Slide Support (LH)	1
J	Drawer End & Slide Support (RH)	1
K	Drawer Bar Front & Back (with holes)	2
L	Top Shelf Bar Back	1
M	Top Shelf Section Front	1
N	Drawer Handles	2
O	Board for Top Shelf	1
P	Boards for Drawer	2
Q	Work surface	1
R	Reinforced Bar	1
S	Pegboard	1
T	Pegboard Hooks	10
U	Nuts and Bolts	38/38
V	Plastic feet	8
W	Bottle shelf	1

TOOLS REQUIRED:

- Mallet
- Pozi drive Screwdriver
- 8mm Spanner

SAFETY TIPS

- Sharp metal edges please handle carefully

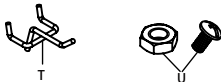

Step 1:

Attach plastic feet (V) to the Leg angle (B)

NOTE: Insert the corner of the leg into the corner of the cap first, then gently push the rest of the cap onto the leg.

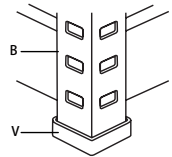

Step 2:

Fit One Short Shelf Support (D) between Two Leg Angles (B), leaving two clear slots at the bottom of the Leg Angles. Repeat this with the other Two Leg Angles, making sure both Short Shelf Supports are at the same height. Fit Two Long Shelf Supports (C) level with the Short Shelf Supports. Always Mallet gently, being sure the shelf support tabs are in line with the leg angle slots. If the tabs are out of line, simply bend them to line up either way to suit. Do not use force and damage the tabs.

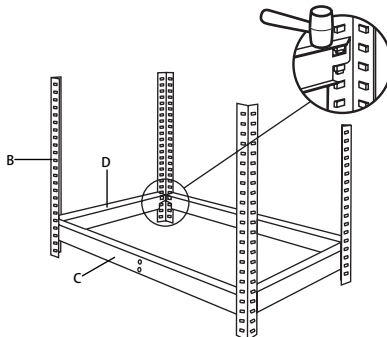

STEP 3:

Fit the Right Hand Bracket with Roller Bearing Drawer Slide Attached (H). Leave two clear slots from the top as illustrated. Repeat this step for the Left Hand Bracket with Roller Bearing Slides (G). Fit the Centre Shelf Support (E) with the flat surface facing up, using Four Nuts and Bolts (U).

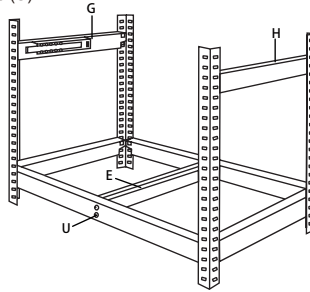

STEP 4:

Fit Two Short Shelf Supports (D) and Two Long Shelf Supports (C) in the vacant two slots at the top of the Leg Angles. Fit the other Centre Shelf Support (E) with the flat surface facing up, using Four Nuts and Bolts (U).

Note: The Two Nuts and Bolts (U) fixed in the Long Shelf Supports Bar Back (C) should be loosely tighten then you need to re-screw the Reinforced Bar (R) later in step 5.

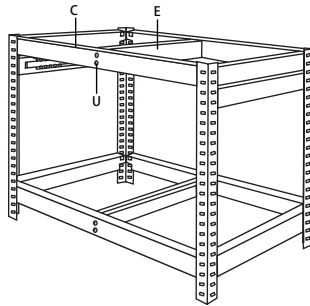

STEP 5:

Bolt Two Pegboard Angles (A) to the Leg Angles (B). Overlap the joining angles and leave 600mm protruding at the top, measuring from the bench top upwards. Use Four Nuts and Bolts (U) to join the angles where the pre-drilled holes line up. Attach the Top Shelf Bar Back (L) in the two vacant slots at the top of the Pegboard Angles (A). Attach the Reinforced bar (R) in the back of the Top Shelf Bar Back (L) and the Long Shelf Supports Bar Back (C), using Four Nuts and Bolts (U) to join where have the pre-drilled holes line up vertical.

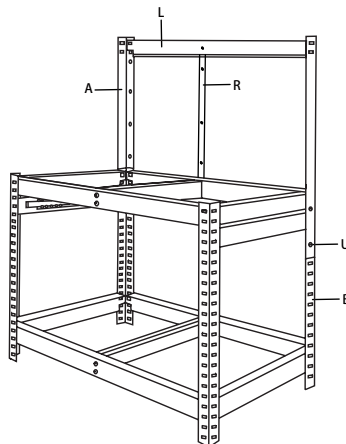

STEP 6:

Use the clearly marked Drawer Ends (I), (J) for the left and right sides. Tap the Drawer Bar Front & Back (with holes) (K) sections into the sides and install the Drawer Centre Divider (F) with Four Nuts and Bolts (U). Install the Two Boards (P) into the Drawer by sliding them in from each side.

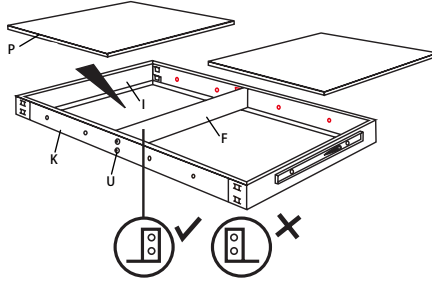

STEP 7:

Attach the Top Shelf Section Front (M) to the Pegboard Angles (A) using a mallet. Fit Metal Pegboard (S) to Pegboard Angles (A). Use Eight Nuts and Bolts (U) to join to Pegboard Angles (A). Drill new holes in the pegboard if necessary. Another use Three Nuts and Bolts (U) to join the pre-drilled holes overlap between the Pegboard (S) and the Reinforced bar (R).

Note: Fit the screws in from the pegboard side. Slide in the Drawer by lining up the slides on the Workshop with the slide support on the Drawer.

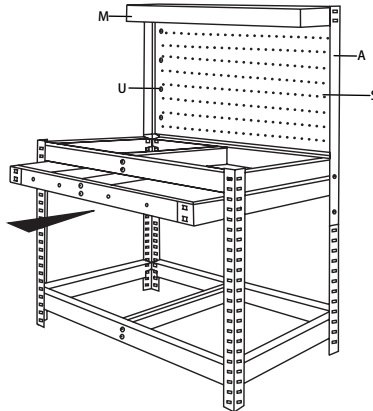

STEP 8:

Drop the Board for the Top Shelf (O) into the Top Shelf cavity made. Attach the Handles (N) to the Sliding Drawer using Four Nuts and Bolts (U). Fit the Work surface (Q) by placing it down onto the frame construction. Fit the another Bottle shelf (W) by sliding it in from the side on an angle. Attach the Plastic Feet (V) to all angle ends.

